

Subscriptions for Enhanced Features:

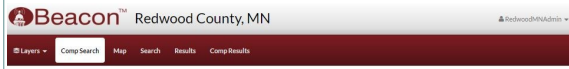

Comparables Search

Use	Category	Criteria
<input type="checkbox"/>	Acreage	Between <input type="text"/> and <input type="text"/> ac
<input type="checkbox"/>	Est. Mkt Val	Between <input type="text"/> and <input type="text"/>
<input type="checkbox"/>	Purchase Price	Between <input type="text"/> and <input type="text"/>
<input type="checkbox"/>	Sale Date	<input type="text"/> 1 Month <input type="text"/>
<input type="checkbox"/>	Class	1 TO 3 UNIT DWELLING 2A FARM ENTRY 1ST TIER 4 OR MORE NC - 16 TO 20 D1 4 OR MORE UNITS
<input type="checkbox"/>	Twp/City	50 <input type="text"/> 51 <input type="text"/> 52 <input type="text"/> 53 <input type="text"/>
<input type="checkbox"/>	School	85 <input type="text"/> 405 <input type="text"/> 640 <input type="text"/> 2290 <input type="text"/>

[Search](#) [Returns top 200 results](#) [Clear](#)

- Comparable property search which gives you the ability to select properties comparable to a selected property or criteria entered.

85-200-1492	#REDWOOD COUNTY (Twp)	403 MILL ST R/W F S	56283
85-200-2280	#REDWOOD COUNTY (Twp)	415 MILL ST R/W F S	56283
85-200-2320	#REDWOOD COUNTY (Twp)	303 THIRD ST E	56283
85-200-2350	#REDWOOD COUNTY (Twp)	720 MAIN ST WAB	56293
85-729-1190	#REDWOOD COUNTY (Twp)	2033 MAIN ST WAB W	56293
91-030-4040	#REDWOOD COUNTY (Twp)	95 MAIN ST W/LGR	56180
93-200-0760	#REDWOOD COUNTY FARM BUREAU (Twp)	312 ST MATTHIAS BVD WAB W	56294
93-270-0490	#REDWOOD COUNTY (Twp)		
94-030-2142	#REDWOOD COUNTY (Twp)		
94-200-2000	#REDWOOD COUNTY (Twp)		
95-019-4175	#REDWOOD COUNTY (Twp)		

Mailing Label Generator

Download format: Address labels (5,660)

Additional mailing label options: ☐ Show parcel id on label

Skip labels:

[Download](#)

- Mailing label generator allows you to create a mailing list based on properties selected.



- Oblique Pictometry® imagery allows you to view the entire 360° of a property.
- Enhanced assessment information (as available).

One Year Option:

1-5 users: \$500.00
6-10 users: \$550.00
11+ users: \$600.00

One Month Option:

\$50.00 / user

One Week Option:

\$20.00 / user

Need For Public Online GIS

The need to access local government information often occurs outside of normal office hours. The ability to access Redwood County information such as property boundaries, sales, taxes, drainage ditch tile, DNR buffers, and much more from your home, business, or in the field via computer, tablet, or any mobile device is now available through Beacon™.

Redwood County received assistance with this project from the Blandin Foundation though a Broadband Grant to help fund the creation of this public interactive mapping site.



Blandin Foundation™
STRENGTHENING RURAL MINNESOTA



**Redwood County
Environmental Office
P.O. Box 130
Redwood Falls, MN 56283
Phone: 507-637-4023
Fax: 507-637-4062**



Redwood County Online GIS

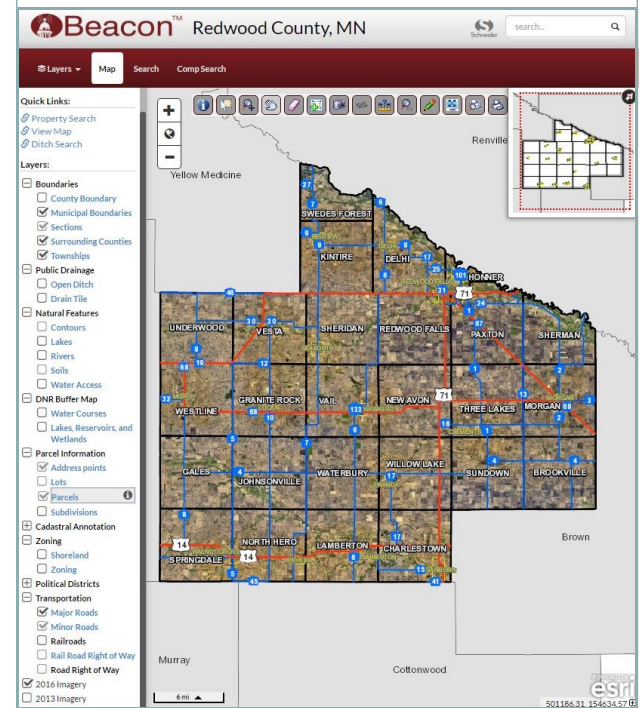

Ways to Access Redwood County GIS

<http://www.co.redwood.mn.us/>

- Click the "Beacon™ Online GIS" button on the home page <http://beacon.schneidercorp.com/>
- Use the dropdown menus to select Redwood County



What is GIS?

Geographic Information System (GIS) is a system designed to capture, store, manipulate, analyze, manage, and present all types of spatial or geographical data. Simply, GIS is information with a location.

What is Beacon™?

Beacon™ is an easy to use interactive online geographic information system (GIS) which allows users to view Redwood County spatial information overlaid on ultra-high resolution aerial photography better than Google Earth. Beacon™ also includes a wide range of tools to help you identify and analyze information, print out property information reports, and create annotated aerial maps of your farm land, hunting land, recreation area, construction area, or any other area of interest that you would like to have a colored map with information.

Everyone can benefit from using Beacon™

This information is all available to the public with advanced subscription options that can improve business efficiency and functionality to all citizens including, but not limited to, General Public, Farmers, Business Owners, Real-estate firms, Attorneys, Surveyors, Financial Services, Contractors, Utility Companies, Marketing, etc.

How to use Beacon:

Redwood County, MN

Layers Search Map Comp Search

Search by Owner Name

(Enter any part of the name.)
(Do not include commas.)
(Includes only current names.)

Search by Property Address

(Do not include prefixes or suffixes - i.e. Dr, St, Ave, North, etc...)
(Only the first address will be displayed on parcels with more than one address assigned.)

Search by Parcel Number

(e.g. 3000000000)

Township Range Search

Township
--Please select a Township--

Section
--Please select a Section--

County Ditch Search

[County Ditch Search](#)

(Above) The search option gives you the capability to look up a property by entering either an owner name, property address, parcel number, or township/section/range. Beacon™ creates a list of results for every property that contains any of the content entered into the search option. Clicking the parcel ID of the property you are inquiring about will generate a parcel report.

(Left) Example of a typical parcel report generated by Beacon™.

Within this report, you can click on the Map Tab on the red banner and this will zoom you to the location of the property.

There is also the ability to search by county drainage system by entering in the name of the drainage system, i.e. CD 12, JD 33, etc.

Printable/Downloadable Maps:

Beacon™ gives you the ability to create your own maps by selecting the area of interests, making necessary annotations, and selecting information you would like included for reference in the map.

Print Options

Paper size:
8.5x11 Portrait

Print Quality:
Medium (350 dpi)

Map Scale:
Current view

Title:

Subtitle:

Author:

Map Scale Note:

☒ Header
☒ Overview
☒ North Arrow

☒ Title
☒ Legend
☒ Scale Bar

☒ Footer
☒ Details

Preview:

(Above) Print setup options that allow you to choose what features you would like to see on the output map. (Below) The output map has all of the feature selected such as title, subtitle, author, overview, legend, scale bar, north arrow, date of map creation, and date/time of the last data upload.

Redwood County, MN

City of Redwood Falls

Beacon Overview

Created by: Redwood County GIS

Date created: 3/24/2017
Last Data Uploaded: 3/24/2017 10:14:23 AM

Developed by The Schneider Corporation