

Redwood County Highway Department

1820 East Bridge Street
Redwood Falls, MN 56283
Phone: (507) 637-4056 Fax: (507) 637-1201



March 12, 2026

RE: County-Wide Reflectorized Pavement Markings on Designated Roadways

Dear Contractor,

Redwood County is seeking quotes from contractors to provide County-Wide Reflectorized Pavement Markings on designated roadways. Interested companies should return the enclosed quote by 10:00 a.m. on Tuesday, April 14, 2026. Complete quote may be submitted via standard mail, email (rchd@redwoodcounty-mn.gov) or fax to the Redwood County Highway Department. The expected award date is Tuesday, April 21, 2026.

If you have questions, please contact Matt Guetter, Senior Sign Specialist at cell 507-829-9278, office 507-637-1216 or email matthew_g@redwoodcounty-mn.gov.

Regards,

Nicholas Klisch

Nick Klisch, P.E.
Redwood County Engineer
rchd@redwoodcounty-mn.gov

Jacqueline Reck

Accountant
Jacqueline_r@redwoodcounty-mn.gov

Robin Kokesch

Administrative Assistant/Accounting Technician
Robin_k@redwoodcounty-mn.gov

GENERAL REQUIREMENTS

A-1 AFFIRMATIVE ACTION RESPONSIBILITIES

All bidders shall meet with the County's Affirmative Action requirements. If a bidder does not meet the requirements, the County reserves the right not to consider the bid.

The County Board shall take action to terminate any contractual agreement between the County and any supplier, vendor, contractor or subcontractor who is found to be in violation of the County's Affirmative Action requirements.

All bid specifications, proposals and contracts shall require contractors, subcontractors and vendors having 15 or more employees to submit the following:

1. A signed statement certifying that the contractor, subcontractor or vendor fully intends to comply with the standards of equal employment and anti-discrimination as cited in the Civil Rights Act of 1964, as amended in 1972, by the Equal Employment Opportunity Act.

A-2 INDEPENDENT CONTRACTOR STATUS

Contractor is to be and shall remain an independent contractor with respect to any and all work performed under this Contract. Nothing in this Agreement shall be construed as creating the relationship of co-partners, joint ventures, or an association, nor shall the Contractor, be considered an employee, agent or representative of the County. Contractor acknowledges and agrees that Contractor is not entitled to receive any of the benefits received by Redwood County employees and is not eligible for workers' or unemployment compensation benefits under Redwood County.

A-3 INDEMNIFICATION

Any and all claims that arise or may arise against Contractor, its agents, servants or employees as a consequence of any act or omission on the part of Contractor or its agents, servants or employees while engaged in the performance of the Contract shall in no way be the responsibility or obligation of the County. Contractor shall indemnify, hold harmless and defend the County, its officers and employees against any and all liability, loss, costs, damages, expenses, claims or actions, including attorney's fees which the County its officers or employees may hereinafter sustain, incur or be required to pay, arising out of or by reason of any act or omission of the Contractor, its subcontractors, partners, independent contractors, its agents, servants or employees, in the execution, performance or failure to adequately perform Contractor's obligations pursuant to this Contract. This indemnification obligation shall not be limited in any way by the insurance coverages required under this Contract. Nothing in this Contract shall constitute a waiver by the County of any statute of limitations or exceptions on liability.

A-4 INSURANCE

Contractor shall procure and maintain for the duration of the Agreement, insurance coverage for injuries to persons or damages to property which may arise from or in connection with the performance of the work hereunder by Contractor.

1. MINIMUM SCOPE OF INSURANCE: Coverage shall be at least as broad as follows:
 - a. General Liability coverage (occurrence form CG 00 01 or a substitute form providing equivalent coverage), and shall cover liability arising from premises, operations, independent contractors, products-completed operations, personal injury, advertising, and liability assumed under an insured contract (including the tort liability of another assumed in a business contract). County **must be named as additional insured**. An excess or umbrella liability policy may be used in conjunction with primary coverages to meet the minimum limit requirements. County must also be named as additional insured on the excess or umbrella policy.
 - b. Automobile Liability coverage shall be written on ISO form CA 00 01, CA 00 05, CA 00 12, CA 00 20, or substitute for providing equivalent liability coverage. Such insurance shall cover liability arising out of any auto (including owned, hired, and non-owned autos). County **must be named as additional insured**. An excess or umbrella liability policy may be used in conjunction with primary coverages to meet the minimum limit requirements. County must also be named as additional insured on the excess or umbrella policy.
 - c. Workers' Compensation as required by the State of Minnesota, and Employer's Liability insurance. If Contractor's employment is an excluded employment under Minn. Stat. § 176.041 and Contractor elects not to purchase workers' compensation coverage, Contractor shall provide County with a written waiver of workers' compensation coverage in a form acceptable to County. Contractor agrees that under no circumstances shall County be responsible for workers' compensation for injuries suffered in connection with this Agreement.
2. MINIMUM LIMITS OF INSURANCE: Contractor shall maintain **NO LESS THAN** the following limits of insurance:
 - a. General Liability Insurance, and if necessary, Umbrella Liability:
 - \$1,500,000 per occurrence
 - \$3,000,000 annual aggregate
 - \$3,000,000 products and completed operations aggregate
 - b. Business Automobile Liability and if necessary, Umbrella Liability:
 - \$1,500,000 per occurrence
 - \$3,000,000 aggregate
 - c. Worker's Compensation:
 - as required by the State of Minnesota

- d. Employer's liability coverage with minimum limits of:
 - Bodily injury by accident: \$500,000 each employee
 - Bodily injury by accident: \$1,500,000 each incident
 - Bodily injury by disease: \$500,000 each employee
 - Bodily injury by disease: \$1,500,000 policy limit

- f. Professional/Technical Liability or Errors and Omissions:
 - \$2,000,000 per occurrence – Errors & Omissions
 - \$2,000,000 per occurrence – Bond (conduct by employee constituting malfeasance, willful neglect of duty or bad faith)
 - \$4,000,000 annual aggregate

3. DEDUCTIBLES AND SELF-INSURANCE:

- a. Any deductibles will be the sole responsibility of Contractor and may not exceed \$50,000 without the written consent of County. Any request for a higher deductible must first be approved by County after Contractor provides County with financial documentation sufficient for County to determine whether Contractor has the financial resources to cover the requested deductible.

4. ADDITIONAL INSURANCE CONDITIONS:

- a. Contractor's insurance shall apply as primary insurance with respect to any other insurance or self-insurance program maintained by County. County's insurance or self-insurance program shall be excess of Contractor's insurance and shall not contribute to it.
 - b. Any failure to comply with reporting provisions of the policies shall not affect coverage provided to County or its officers, officials, employees or volunteers.
5. Contractor must obtain insurance policies from insurance companies having an "AM BEST" rating of A:VII or better and authorized to do business in the State of Minnesota.

6. VERIFICATION OF COVERAGE:

Contractor shall provide County with certificates of insurance and original endorsements showing that Contractor has each type of insurance coverage and limits required under this Agreement. A Certificate of Insurance for each policy must be on file with County within 10 days of execution of this Agreement and prior to commencement of any work under this Agreement. Each certificate must include a 10-day notice of cancellation, nonrenewal, or material change to all named and additional insureds. If insurance expires during the term of this Agreement a new Certificate of Insurance must be provided to County at least 10 days prior to the expiration date. The new insurance must meet all the same terms as outlined in this Section A-6. The County reserves the right to rescind any contract not in compliance with these requirements and retains all rights thereafter to pursue any legal remedies against Contractor. All subcontractors

shall provide evidence of similar coverage.

A-5 MUNICIPALITIES

Striping in Municipalities will consist of centerline and no-pass as directed by the Engineer.

A-6 EDGE STRIPE

4" wide solid line - edge stripe.

- (a) Turn lanes as directed by Engineer. Obtain specific information before beginning work at each location.
- (b) All edge line stripes are 0.5 foot from edge of bituminous pavement when lane widths are 12 feet or greater.

A-7 BATCH CERTIFICATION

Contractor shall complete, sign, and have notarized, for each color of paint, the forms for Certification of Traffic Paint batch formulation.

A-8 LENGTH OF PROJECT

This project consists of REFLECTORIZED PAVEMENT MARKINGS. See the striping summary sheets included herein the proposal for lengths and miles. Work to begin May 27, 2026 and be completed no later than September 4, 2026. Redwood County has the right to require the Contractor to perform the work in two phases, with the Early Phase completion being required within twenty-five (25) calendar days of notification. Failure to complete the Early Phase work within the twenty-five (25) calendar days' time span will **result in a one-time liquidated damages deduction of \$900** pursuant to specification 1807, and will have no further impact on the other terms of this contract. Liquidated damages for final completion remain in effect pursuant to specification 1807.

A-9 EQUIPMENT LIST

Each bidder shall submit with his bid a complete list of equipment to be used in the work specified herein including size, model and year of manufacture. Failure to include such a list may result in rejection of the bid.

REDWOOD COUNTY MINNESOTA HIGHWAY MAP

2026 STRIPING

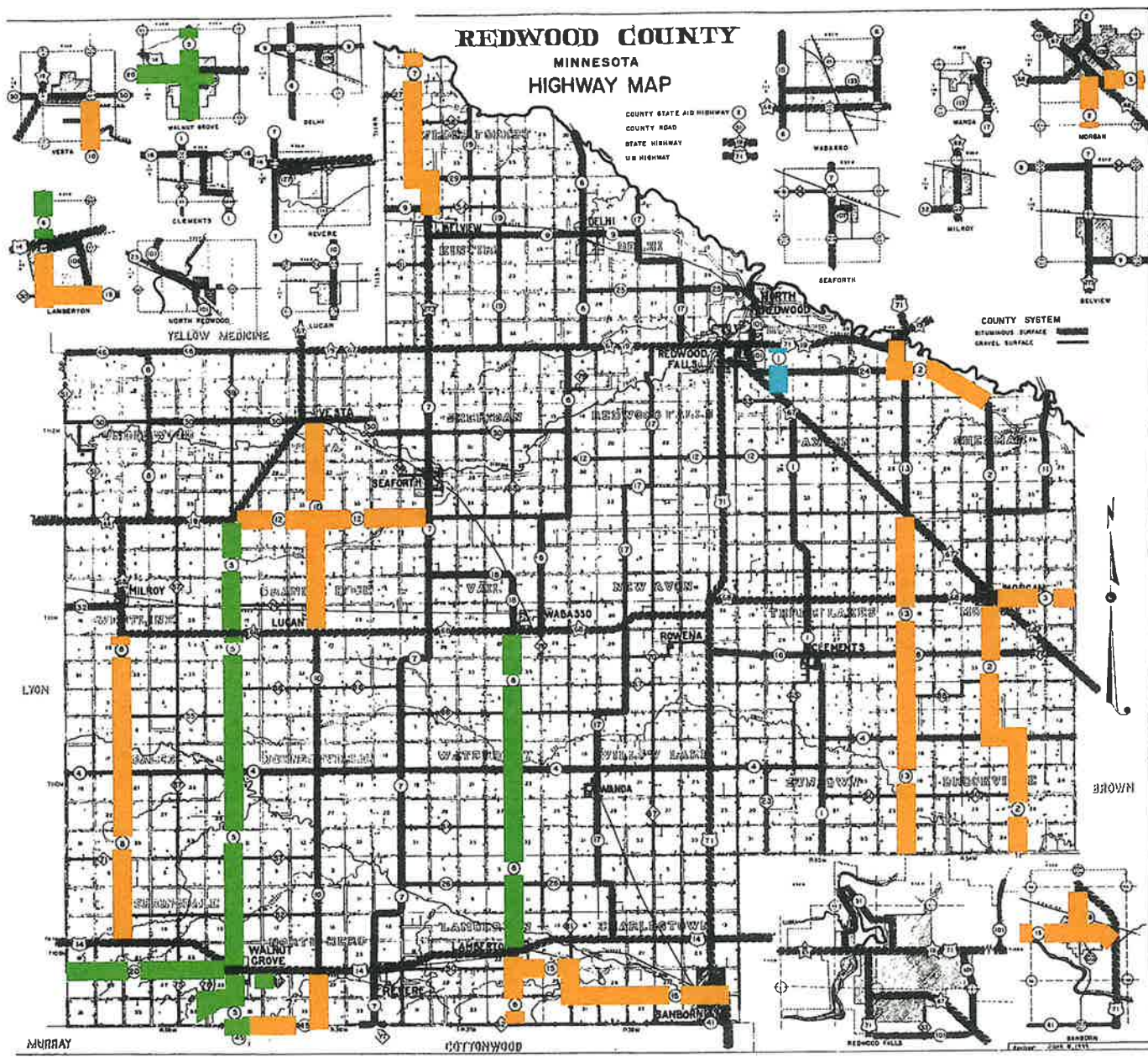

- = C/L ONLY
- = RESTRIPE
- = SEALCOAT

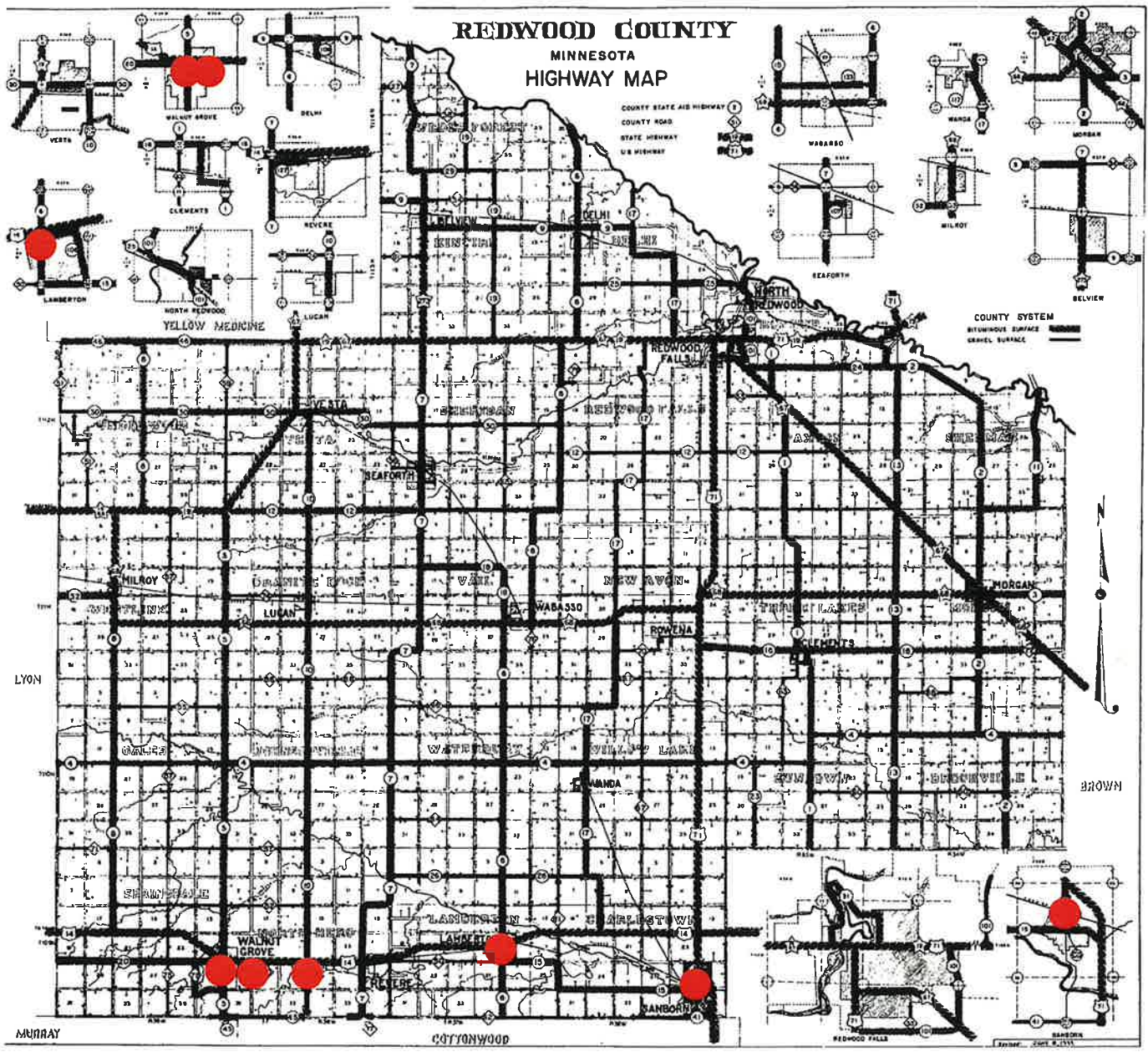

2026 RR Crossings

● = R/R CROSSING

REDWOOD COUNTY STRIPING 2026

Approximate quantities:

Solid Yellow Paint ----- 370,940 ft.

Broken Yellow Paint ----- 100,312 ft.

Solid White Paint ----- 1,216,436ft.

Railroad Crossings With Stop Bars----5 Crossings x 2

Approximate miles:

All Striping ----- TOTAL: 114 miles

STRIPING 2026

ROUTE	TYPE	SYLENGTH	BYLENGTH	SWLENGTH	BWLENGTH	LOCATION
C.R 78	SEALCOAT	16,798	6,518	24,222	0	CSAH 5 TO CSAH 20
C.R 80	SEALCOAT	1,019	1,220	2,856	0	TWP.RD. TO T.H. 14
CSAH 1	C/L ONLY	11,570	5,589	0	0	T.H. 67 TO T.H 19 & 71
CSAH 2	RESTRIPE	26,078	51,150	104,002	0	SO.CO.LINE TO T.H 68
CSAH 2	RESTRIPE	20,254	25,701	53,932	0	305TH ST TO T.H 19 & 71
CSAH 3	RESTRIPE	775	15,436	30,872	0	T.H 68 TO EAST CO. LINE
CSAH 5	SEALCOAT	37,757	94,364	188,032	0	T.H 19 TO SOUTH CO. LINE
CSAH 6	SEALCOAT	40,835	51,763	121,744	0	T.H 14 TO T.H 68
CSAH 6	RESTRIPE	12,054	10,416	26,980	0	SOUTH CO. LINE TO T.H 14
CSAH 7	RESTRIPE	34,384	20,092	64,016	0	CSAH 9 WEST TO NORTH CO. LINE
CSAH 8	RESTRIPE	30,943	11,011	118,764	0	T.H. 68 TO T.H. 14
CSAH 10	RESTRIPE	13,892	40,103	77,848	0	T.H. 68 TO CSAH 30
CSAH 10	RESTRIPE	14,411	6,483	22,266	0	CSAH 45 TO T.H 14
CSAH 12	RESTRIPE	25,147	30,530	75,800	0	T.H 19 TO CSAH 7
CSAH 13	RESTRIPE	21,375	60,089	125,126	0	T.H. 67 TO SOUTH CO. LINE
CSAH 15	RESTRIPE	23,981	35,884	88,142	0	T.H.71 TO CSAH 6
CSAH 20	SEALCOAT	26,074	25,348	63,522	0	CSAH 5 TO WEST CO. LINE
CSAH 45	SEALCOAT	1,592	2,216	4,894	0	COTTONWOOD CO. 20 TO CSAH 5
CSAH 45	RESTRIPE	5,465	7,164	15,288	0	CSAH 10 TO COTTONWOOD CO. 20
CSAH 105	SEALCOAT	2,640	0	0	0	T.H. 14 TO CSAH 5
CSAH 115	RESTRIPE	3,896	487	8,130	0	CSAH 15 TO T.H. 71
		370,940	100,312	1,216,436		

**REDWOOD COUNTY HIGHWAY DEPARTMENT
SCHEDULE OF QUOTE PRICES**

SPEC. OR ITEM NO.	ITEM DESCRIPTION	UNIT/ MEASURE	APPROXIMATE QUANTITIES	UNIT PRICE	AMOUNT
2582.503	4" BROKEN LINE PAINT (YELLOW)	LF	100,312		
2582.503	4" SOLID LINE PAINT (YELLOW)	LF	370,940		
2582.503	4" SOLID LINE PAINT (WHITE)	LF	1,216,436		
2582.518	RAILROAD CROSSING WITH STOP BAR	EACH	10		

QUOTE TOTAL: _____

QUOTE BY: _____
(NAME OF COMPANY)

(ADDRESS)

(AREA CODE) TELEPHONE (EMAIL)

(SIGNATURE) (DATE)